

## **Rotating Stretch wrapping machine TWIST 2**

Sturdy column construction with rotating wrapping arm. Fixed foil seal system installed near the conveyor; Lifting up and down of the foil carrier and the rotation speed of the wrapping arm can be controlled by frequency inverter.

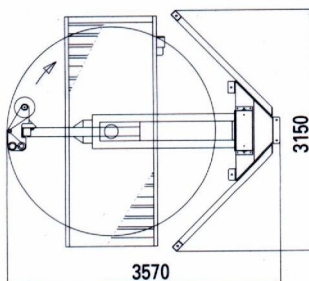

Top view of the machine



### **Description:**

The pallet will be moved to the Rotating wrapper bei conveyor system and exactly centered.

By rotating of the rotating arm around the pallet and lifting of the foil carrier at the same time, there'll be an evenly packaging of the pallet. After the wrapping cycle the foil will be cut and sealed automatically.

### **Advantages of this machine type**

- The pallet needn't to be turned during the wrapping cycle. Because of this, there'll be no pinches.
- The pallet loading can't slip during the whole wrapping cycle.
- Different pallet sizes and height can be used without any modifications.
- For an increased safety of the packaging good, the pallet can be „understretched“. The pallet will be lifted with a special table. (Option).
- The sealing is not at the packaging good.
- With an integrated top sheet dispenser, it is possible to get a packaging which protects the goods against rain and dust. (Option).
- The plant is space-saving and also integrable in conveyor systems - also afterwards.
- Comfortable electronic control unit Siemens S7.

### Technical data

- Machine dimensions (length, width, height) 3500 x 3000 x 3500 mm
- Palett sizes from 1200 X 800 mm up to 1200 X 1000 mm (Standard)
- Palett weight depends on the conveyor.
- Palett height: 150mm
- Palett height with load: 2000mm
- Conveyor height from the ground min. 400mm
- Max. Velocity of circulation: 19 rpm
  
- Capacity 25-50 Paletts/hour, depends on the Palett height, wrapping program, conveyor speed, using a top sheet

### Foil wagon:

- Pre-stretching It depends on the set (140, 200, 300)
- You can set the pre-stretching
- Foil winding: motor drive with frequency changer
- To change foil rolls: mechanical
- Foil roll max. diameter: 300mm
- Foil roll width: 500mm

### Turning arm:

- Driving with driving motor
- Starting and stoppage: with frequency changer (you can set it)
- The numbers of max. turning: you can set it on.

### Foil wagon:

- Driving with driving motor
- Starting and stoppage: with frequency changer (you can set it)
- Starting and moving speed: you can set it on.

### Electric connection:

- Standard connection: 380 V, 50 Hz, 3 fázis
- Warning and control circuits: 24 V
- Electromotor safeguard: CE szabvány IP 54

### Pneumatic connection:

- Working pressure: 6 bar
- Air use: 250 NI/Min.
- Security: CE szabvány IP 54.
- Handling panel

### Including:

- Palett height detection by photo cell
- Foil cut device
- Foil sealing
- Rotation speed controlled by frequency inverter
- Regulation of the foil speed
- Motorized pre-stretching (140%, 200%, 310%)
- Foil tension can be controlled additionally
  
- Quick foil change system

### Options:

- Motorized pre-stretching „Power 3000“ (up to 400%)
- Automatic corner protection
- Foil bundling device
- Top press device to fix the packaging good
- Palett conveyor within the plant, motorized, length: app. 3000 mm, height: ca. 450 mm (Standard)
- Integrated top sheet dispenser, automatically adaption for different palett heights
- Blasting device for controlled wrapping of the top sheet
- Palett lift station for palett understretching (option)
- Security fence with electric locked door and security photo cell at the entrance and exit of the machine